

PERFIL TRANSVERSAL - CORTE AA'  
1/20

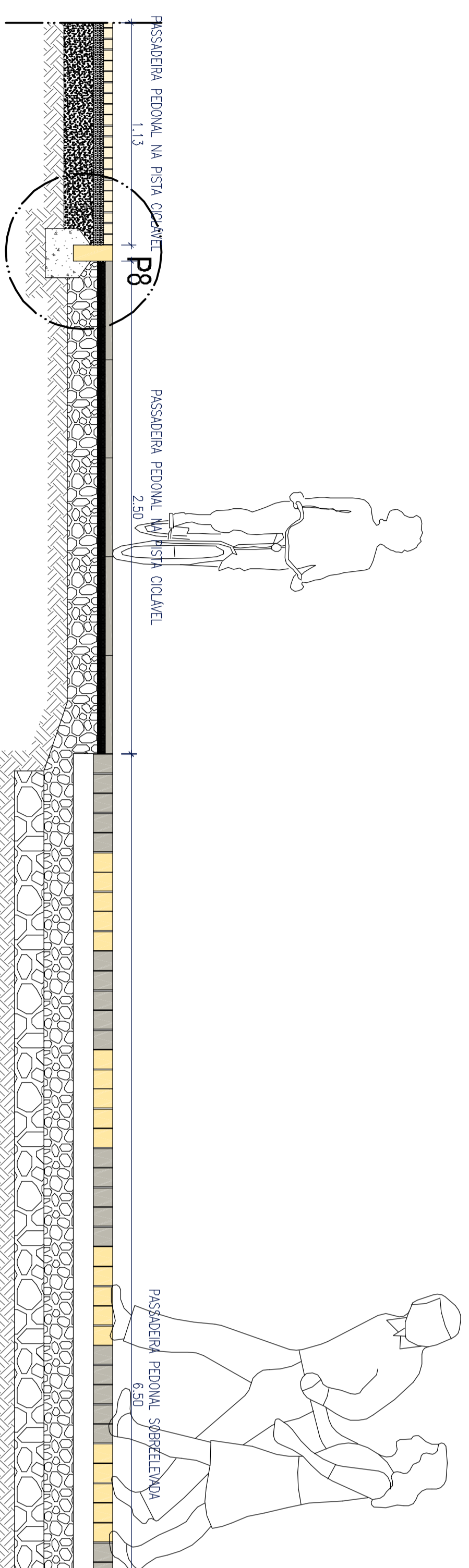

P8 REMATE ENTRE PASSEIO EXISTENTE  
E PASSADEIRA EM LAJE DE GRANITO  
1/10

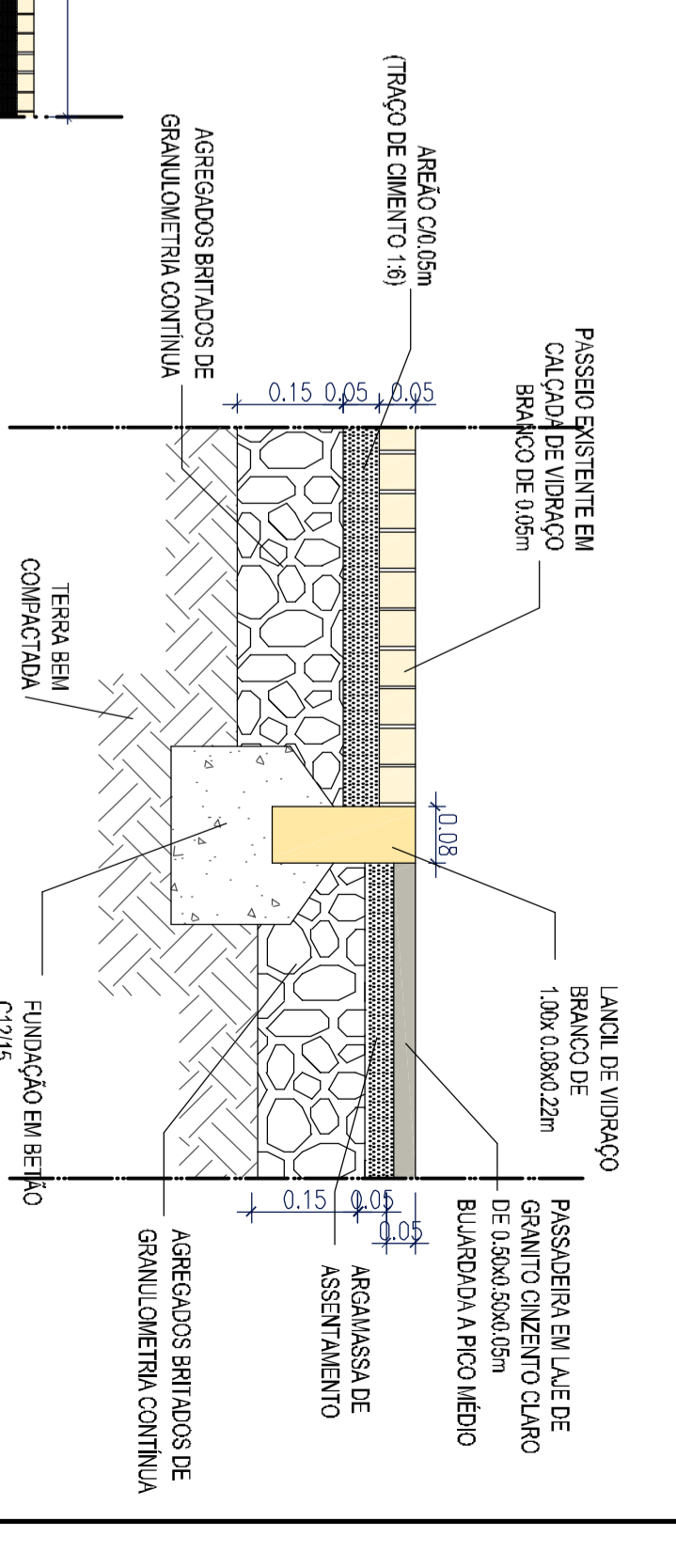

P9 REMATE ENTRE PASSEIO EXISTENTE  
E FAIXA DE RODAGEM DE NÍVEL  
1/10

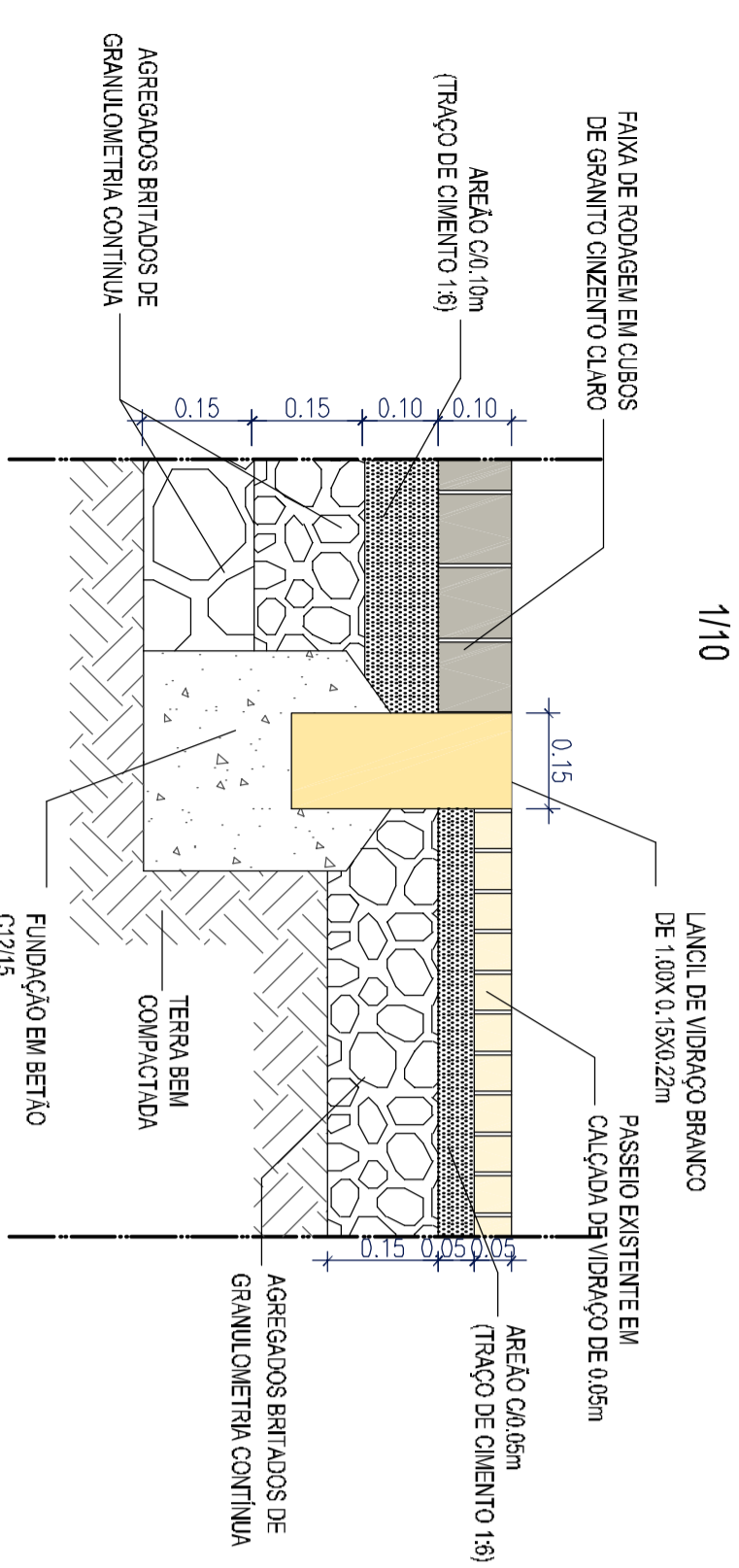

PERFIL LONGITUDINAL - CORTE BB'  
1/20

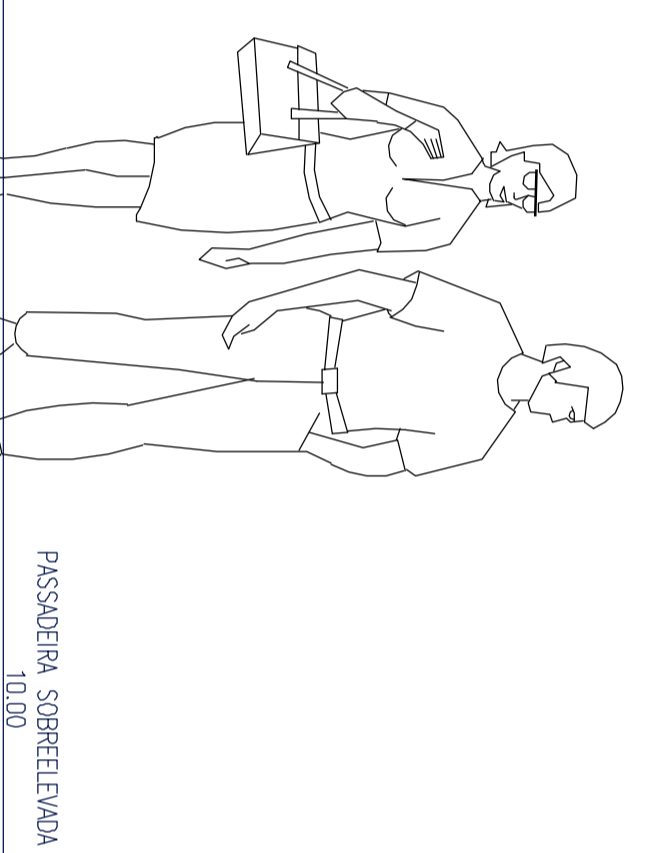

P10 LANCIL LARGO / LOMBADA GALGAVEL EM BLOCOS DE PEDRA  
1/10

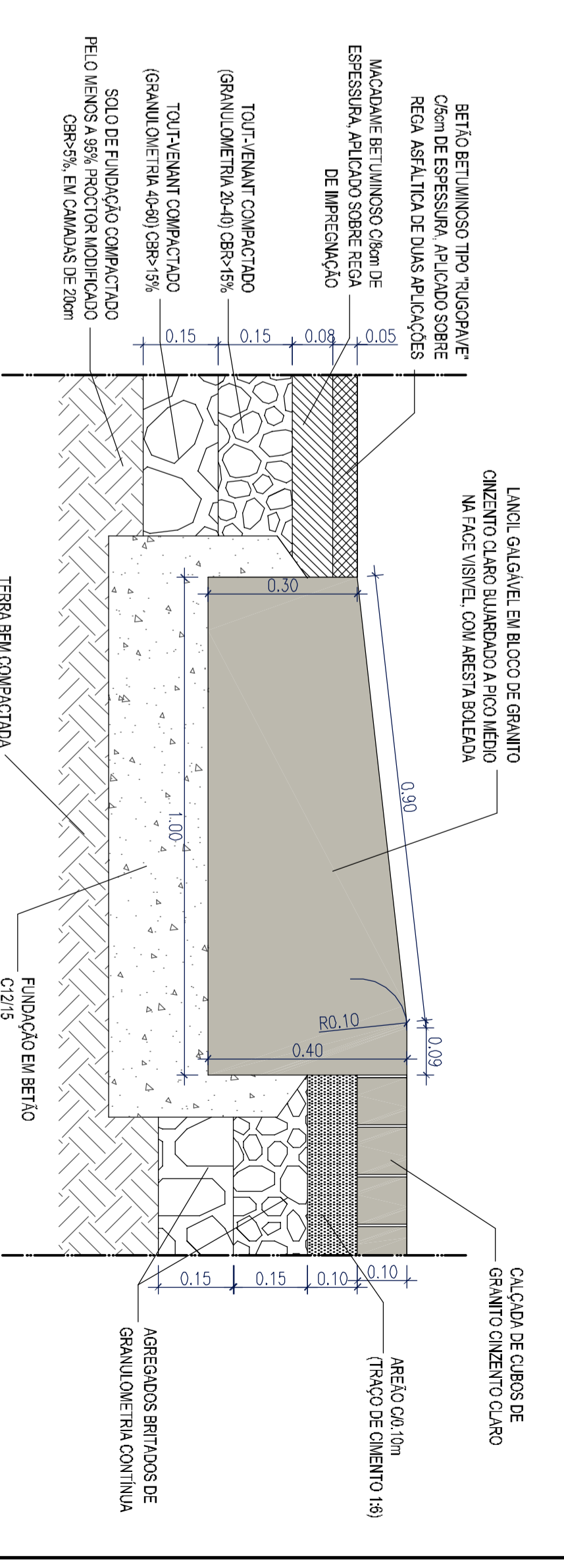

P10

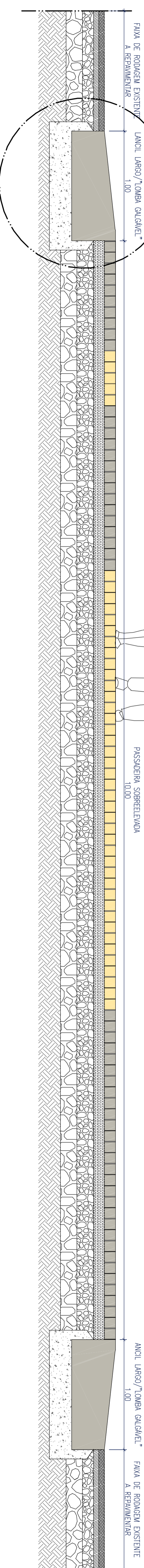

P11 REMATE ENTRE PASSEIO EXISTENTE  
E PISTA EM BETÃO POROSO  
1/10

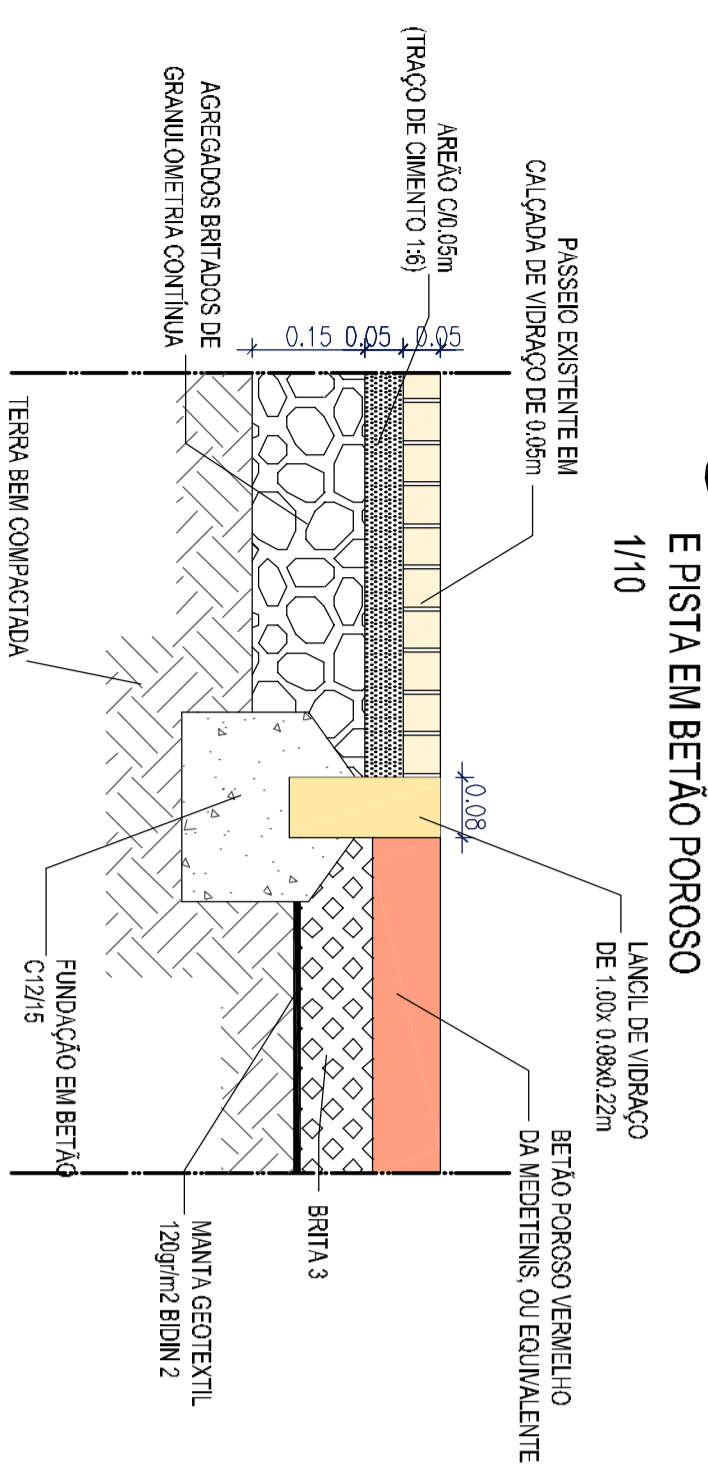

PERFIL TRANSVERSAL - CORTE CC'  
1/20

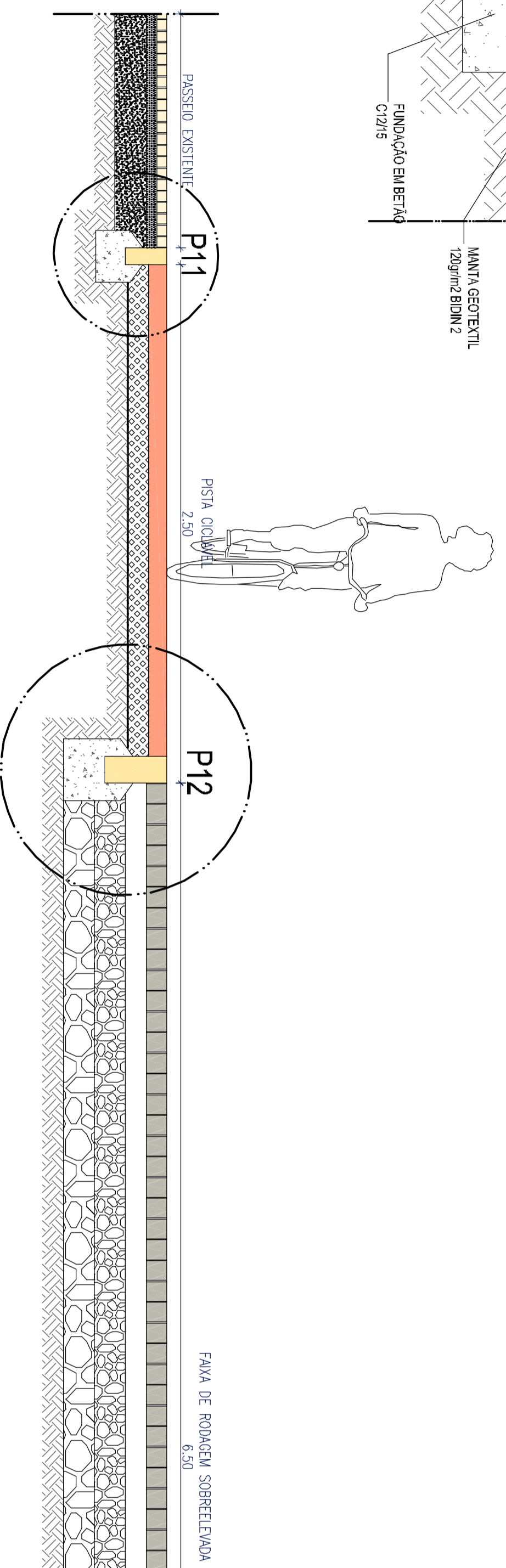

P12 REMATE ENTRE PISTA EM BETÃO POROSO E  
PASSADEIRA SOBRELEVADA EM CALÇADA DE GRANITO  
1/10

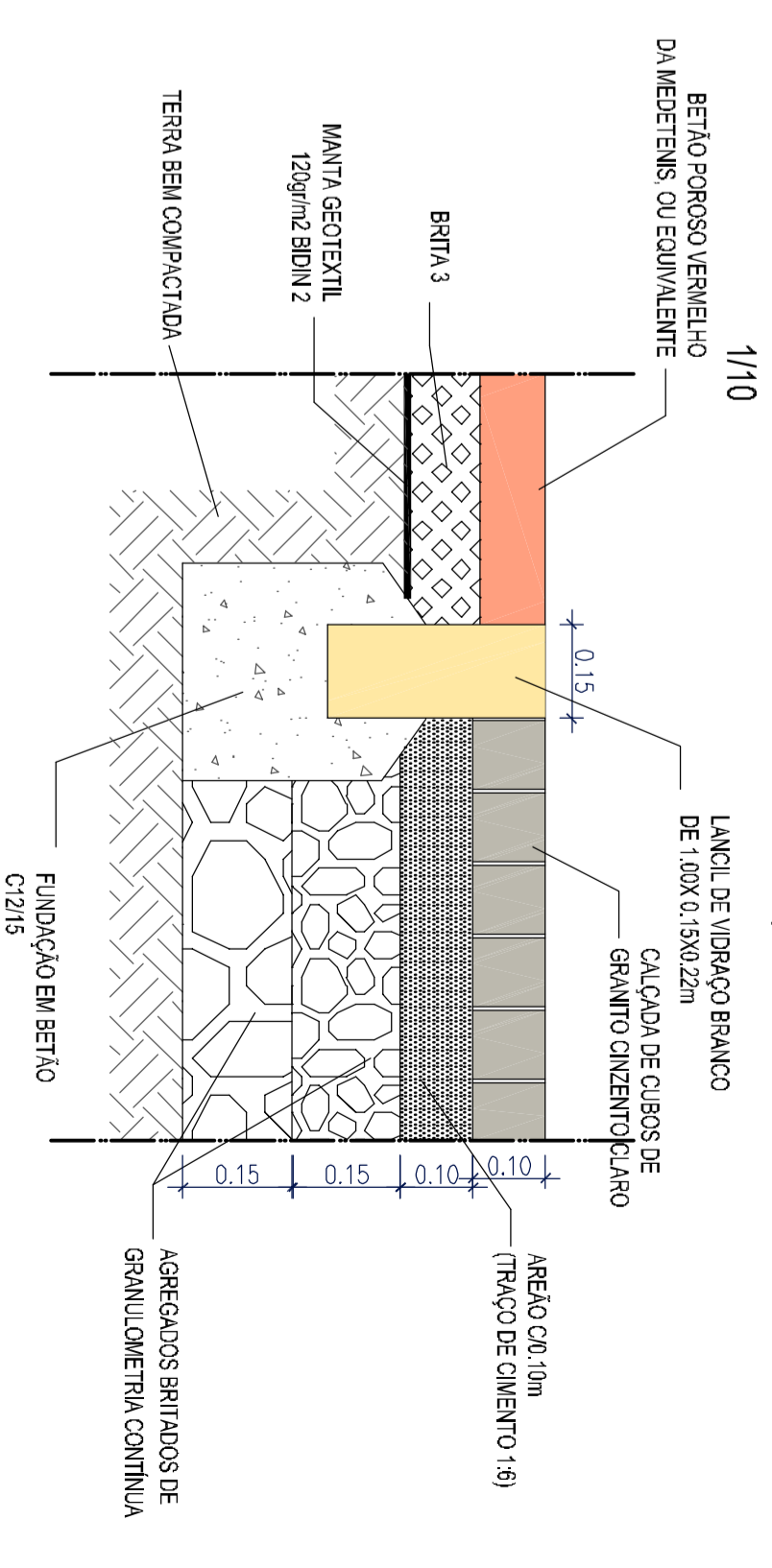

Desenhado: AVENIDA MARGINAL - 3ª FASE  
POMENOR DE PASSADEIRA SOBRELEVADA TIPO  
CORTE E PORTILHORES DE CONSTRUÇÃO  
VARIAS

Escala: 1:20

Data: FEVEREIRO 2017

Técnico: \_\_\_\_\_

ANO	Nº PROJ.	ESPEC.	FASE	REV.	DESA. Nº
					08